

welcome at the Flora Tristán Residence

Made by Amani Belaiba



The first steps in the Flora Tristán Residence and in Seville

Registration in Seville

Health Card of Andalusie

Foreigner's Identity Card; TIE Card

Bus Student Card

*Flora Tristán
Residence*

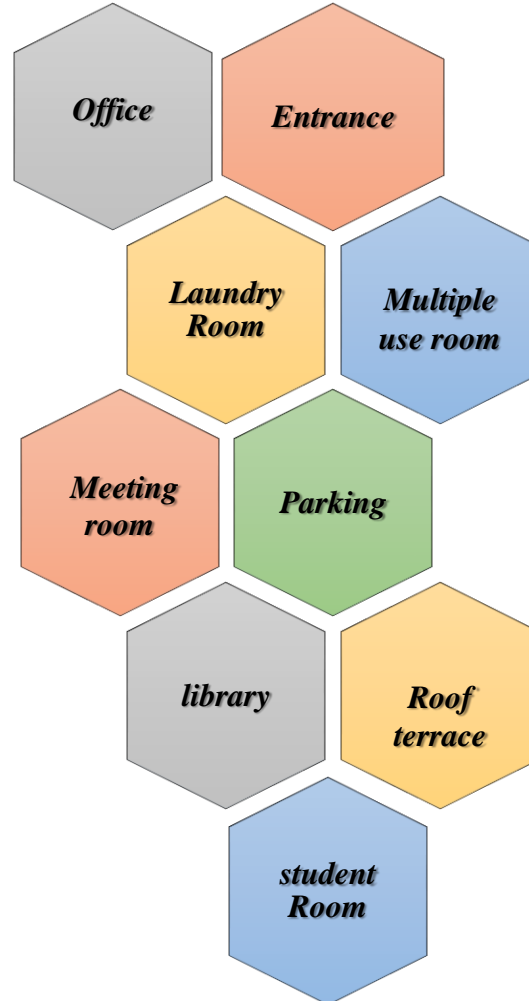

The first steps in the Flora Tristán Residence and in Seville



We offer you a video recorded by me of the Flora Tristán Residence to give you an introduction to how the residence is and all the spaces that form it.

Registration in Seville

The registry office: **Oficina de asistencia en materia de Registro Sur**



C/ Jorge de Guillen, s/n.



955472580, 955472586, 955472597



distrito.sur@sevilla.org



- Documents proving identity (Passport, TIE).
- Correctly filled out registration form.
- Document that justifies the occupation of the dwelling (Rental Contract)



cita previa

- [Plataforma online para solicitud telemática - Participación Ciudadana \(sevilla.org\)](https://www.sevilla.org/servicios/servicio-de-estadística/tramites/solicitud-cita-previa)
- [https:// www.sevilla.org/servicios/servicio-de-estadística/tramites/solicitud-cita-previa](https://www.sevilla.org/servicios/servicio-de-estadística/tramites/solicitud-cita-previa)

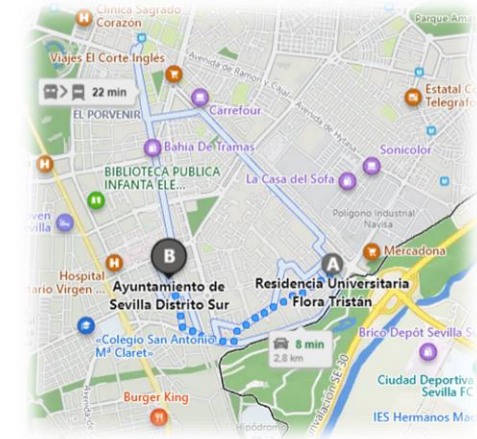

Health Card of Andalusie

CIP: N° de Identificación Personal.
NO corresponde al
N° de Seguridad Social.



ACREDITACIÓN:
FARM-A: Activo
FARM-P: Pensionista



Centro De Salud Las Letanías Dra. Inmaculada Vieira, Calle Madre Amable, 41013, Sevilla



- DNI of the holder
- Accreditation of the right to public health coverage: document issued by the national social security institute as proof of the status of insured person or beneficiary of an insured person.
- Accreditation of residence in Andalusia by means of a census certificate .

➤ *Present the form at your nearest primary care center.*

Download the application form and fill it in:

[extension://elhekieabhbkmcefcobjddigjcaadp/viewer.html?pdfurl=https%3A%2F%2Fwww.sspa.juntadeandalucia.es%2Fservicioandaluzdesalud%2Fsites%2Fdefault%2Ffiles%2Fsincfiles%2Fwsas-media-mediafile_sasdocumento%2F2020%2Fsolicitud_tarj_andalucia_0.pdf&clen=1382643&chunk=true](https://elhekieabhbkmcefcobjddigjcaadp/viewer.html?pdfurl=https%3A%2F%2Fwww.sspa.juntadeandalucia.es%2Fservicioandaluzdesalud%2Fsites%2Fdefault%2Ffiles%2Fsincfiles%2Fwsas-media-mediafile_sasdocumento%2F2020%2Fsolicitud_tarj_andalucia_0.pdf&clen=1382643&chunk=true)

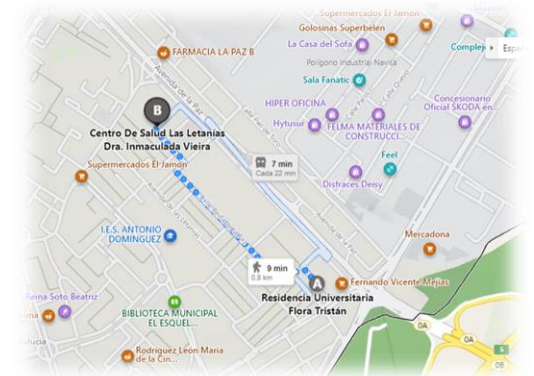

Foreigner's Identity Card; TIE Card

1. Requirements

- You must not hold the nationality of a country of the European Union.
- You must not have been refused entry into Spain.
- Sufficient financial means to cover the costs of your stay and those of your return to your country and, if applicable, family expenses.
- Public or private health insurance and be admitted to an authorized educational institution.

2. Where to apply

- Upon arrival in Seville, you must apply in person for a foreigner's identity card within one month of your entry.
- Foreigner's office in Seville : Plaza de España S/N Torre Norte
- **Previous appointment :** [Proceso automático para la solicitud de cita previa \(administracionespublicas.gob.es\)](http://administracionespublicas.gob.es)

3. Initial procedure

- Present your passport or travel document.
- [Application for foreigner's card model EX-17 available at http://extranjeros.empleo.gob.es/en/ModelosSolicitudes/index.html](http://extranjeros.empleo.gob.es/en/ModelosSolicitudes/index.html).
- Justifying payment of the card fee.
- Pay the fiscal fees Model 790-052: [TASAS - MHAP \(administracionespublicas.gob.es\)](http://administracionespublicas.gob.es)
- Recent color photo, passport size.

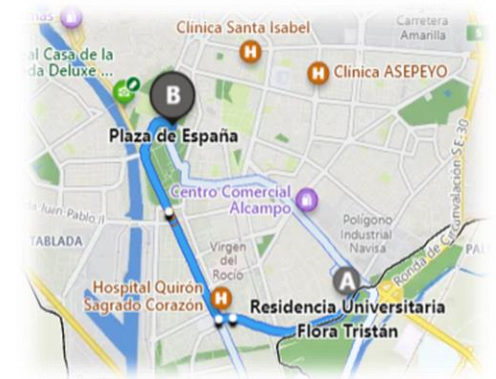

Foreigner's Identity Card; TIE Card

4. Renewal procedure

- Documentation of continuity of studies.
- Use of previous studies.
- The renewal is done at the General Directorate of Police.

5. Current

TIE shall have the same period of validity as the authorization or the recognition of the right that justifies its issuance.

6. Shipping and Delivery

Once the resolution has been notified, you must accredit it and pay the fiscal fees at the police station or foreigners office. the collection is done by appointment.

Pay the fiscal fees Model 790-012: [Tasa790_012 \(policia.gob.es\)](https://www.policia.gob.es)

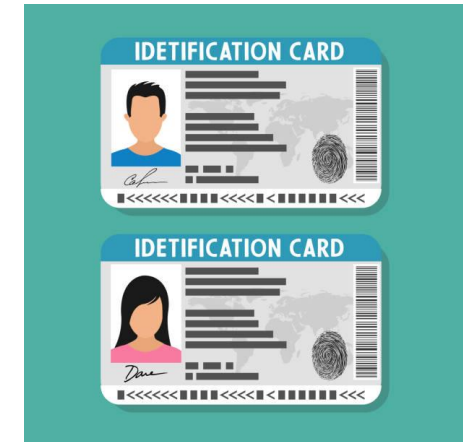

Bus Student Card

Tussam Student Card!

Applications from August 20

Student card September-July

- Nominative card valid for its holder from the current school year with no limit to the number of trips.

Price: 190 euros (possibility of payment fractioned).

Monthly Student Card

- Unlimited travel during the calendar months of the school term.

Price: 19 euros.



Bus Student Card

STUDENT CARD FORM

- Updated color photography.
- Identification document reverse side and back.
- Registration of the academic year for which the card is requested.

WHERE TO APPLY

- Online via the following link:

<https://www.tussam.es/es/formulario-tarjeta-estudiante-mensual> | tussam - transportes urbanos de sevilla, sam.

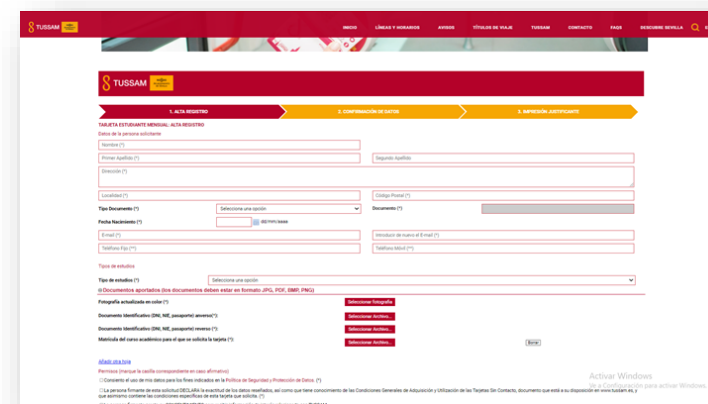

Localization of Tussam office: [Av. de Andalucía, 11, 41007 Sevilla](#)



UNIVERSIDAD
PABLO DE OLAVIDE

Flora Tristán

Residencia
Universitaria

**WELCOME IN OUR HOME AND
OUR FAMILY FLORA TRISTÁN**